



Safe Routes to School

Scoil Bhríde Shantalla Public Consultation Report

Tobin Consulting Engineers and Transport Insights
(on behalf of Galway City Council) | November 2022 – Final Report



Slite Sábháilte
Chun na Scoile
Safe Routes
To School



Rialtas na
hÉireann
Government
of Ireland

Tionscadal Éireann
Project Ireland
2040



Comhairle Cathrach na Gaillimhe
Galway City Council

TOBIN
CONSULTING ENGINEERS



TRANSPORT
INSIGHTS

Public Consultation Report Structure

Introduction

School Zone – Concept Proposal

Consultation Format

Publicising the Consultation



TOBIN
CONSULTING ENGINEERS



Introduction

As part of the Safe Routes to School programme, Galway City Council is engaging with the school community of Scoil Bhríde to develop a 'front of school' design to make it safer for children walking, cycling and scooting to school.

The design will also benefit residents and commuters walking and cycling through their neighbourhood.

- **93% of Scoil Bhríde parents/ guardians support works at the front of school that improve student safety, putting pedestrians & cyclists first**
- **94% of parents/guardians would support works that improve the walking and cycling routes to the school**

(Parents & Guardians Travel Survey 2021)

Galway City Council has developed a design to address concerns expressed by parents/ guardians and has invited public feedback on the Concept proposals.



School Zone Trial in John Dillon Street Dublin City Council

School Zone – Concept Proposal

A 'School Zone's concept design has been developed for Scoil Bhríde 'front of school' on Shantalla Road and Colmcille Road. The concept design is based on the National Safe Routes to School design guidance and incorporates design guidance such as the National Cycle Manual and the Design Manual for Urban Roads and Streets.

Elements Proposed:

- Reducing traffic speeds by:
 - Highlighting the "School Zone" with contrasting surface finish and colour
 - Reduced road width on Shantalla Road
 - Raised tables on Shantalla Road and Colmcille Road
 - Visuals including road markings and signage
- Pencil bollards to prevent parking on footpaths where children are walking
- Improved pedestrian crossing facilities with raised tables and tighter junctions
- Continuous Footways at lightly trafficked vehicle accesses to give 'visual priority' to pedestrians
- Improved pedestrian, scooting and cyclist facilities with wider footway of 3.0m for safer movements
- Proposed Bus lay-by with Bus Shelter on Colmcille Road
- Double yellow lines to discourage parked cars blocking traffic / children's line of sight
- Setdown area within green space on Colmcille Road

Consultation Format

School Zone for Scoil Bhríde:

- The Design Team consulted with representatives from Scoil Bhríde and the Green-Schools Safe Routes to School Infrastructure Officer/ Scoil Bhríde SRTS Delivery Plan, from the end of 2021 until May 2022 in order to prepare the design brought to public consultation.
- Non-statutory public consultation on the concept School Zone ran from the end of May until the 10th of June 2022
- Parents, guardians and the wider school community were invited to share feedback on the proposed design through an online questionnaire. The survey was also available in hard copy on request.
- GCC and the Design Team met with approx. 10 representatives of the Shantalla Residents Association and Local Councillor on the 27th of June 2022 onsite, to talk through the proposal and invite feedback from residents.
- Public consultation on the concept School Zone will inform the design proceeding to the Preliminary Design Stage.

Publicising the Consultation

- An information leaflet was distributed to residents/businesses in the local area summarising the project and inviting feedback.
- The leaflet, scheme drawings, “talk through” presentation and an online survey were available at <https://www.galwaycity.ie/scoilbhridesrts>
- Hard copy surveys were available on request, and submissions in letter/ by phone were also facilitated.
- Scoil Bhríde invited parents and guardians by email to respond.
- Scoil Bhríde also contacted the Residents Committee and requested them to publicise the survey to residents.
- GCC contacted an extensive database, including bus/ taxi operators, cycling representative groups, emergency services, and waste suppliers serving the schools, to participate in the consultation.
- The consultation was publicised on social media, and in the local press.

Leaflet



Slite Sábháilte
Chun na Scoile
Safe Routes
To School



TOBIN
CONSULTING ENGINEERS

TI TRANSPORT
INSIGHTS

Galway City Council Website – Concept Design Drawings

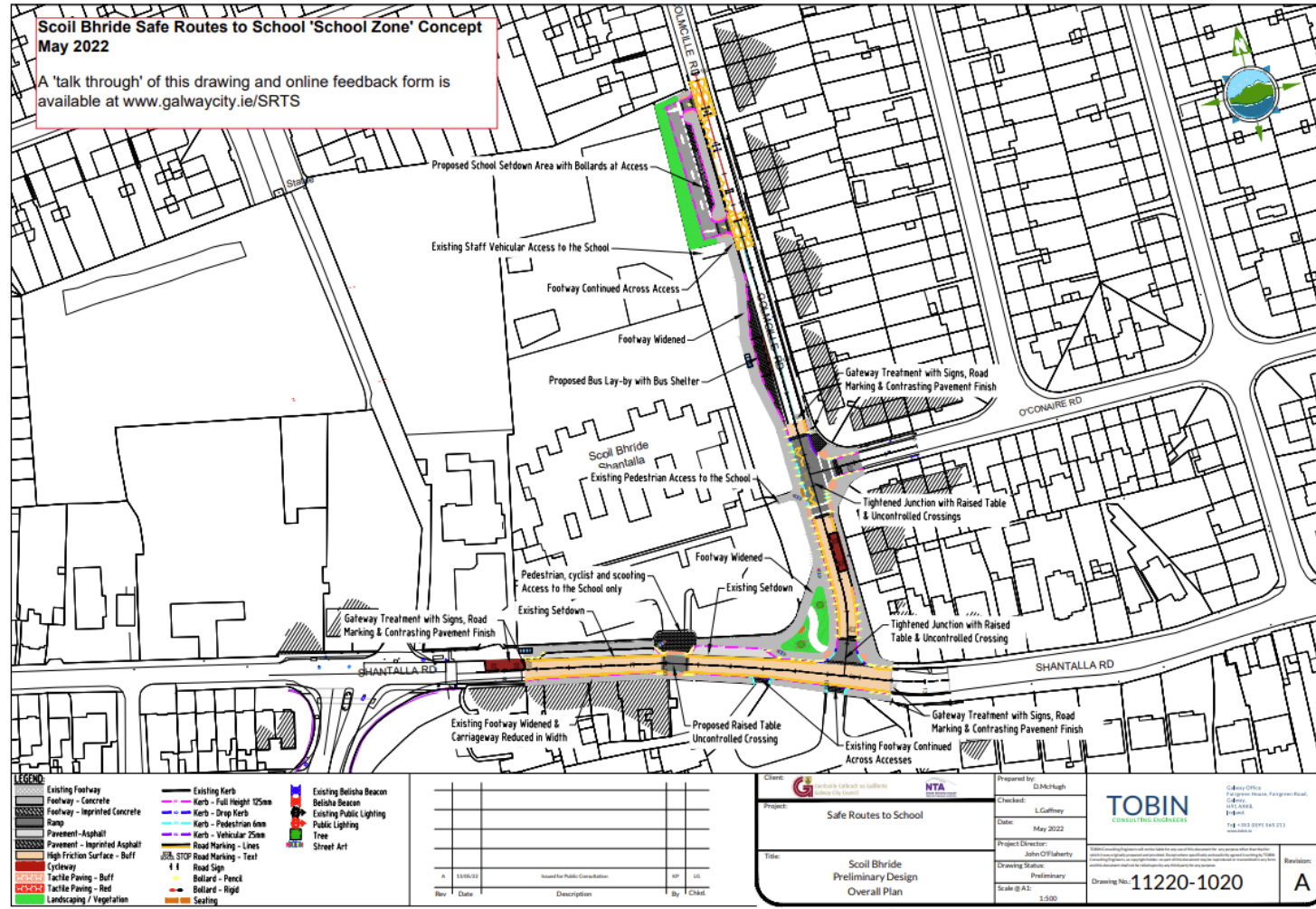

Galway Advertiser

**The Galway Advertiser**
1 June · 🌐

...

As part of the Safe Routes to School programme, Galway City Council is engaging with the school communities of Radharc na Mara NS, Scoil Bhride NS, Scoil Iognáid NS, GET NS and St Joseph's Special School to develop a 'front of school' design to make it safer for children walking, cycling and scooting to school.

The design will also benefit residents and commuters walking and cycling through their neighbourhood.

Feedback, support and comments are now welcome on the concept design now at public consultation, online or in writing by 10th June 2022.

See www.galwaycity.ie/SRTS

[Radharc na Mara School](#)
[The Jes Colaiste Iognaid PPU](#)
[Galway Educate Together](#)
[St. Joseph's Special School](#)
[Scoil Bhride, Shantalla](#)
[TFI - Transport for Ireland](#)
[National Transport Authority](#)
[Green-Schools](#)

'Crios na Scoile'
Comhairliúchán Poiblí

Fáiltíonn Comhairle Cathrach na Gaillimhe roimh thuairimí ar an 'Crios Scoile' atá molta do

- Radharc Na Mara SN, Mervue;
- Scoil Iognáid SN, Bóithrin na Sliogán;
- Galway Educate Together SN/ St Joseph's Special School, Bóthar Thomáis Uí Eithin; agus
- Scoil Bhride SN, Seantalamh.

Feabhsóidh Crios na Scoile 'aghaidh na scoile' chun é a dhéanamh níos sábháilte do leanaí atá ag teacht ar ais agus ón scoil.

Tá léaráidí agus 'caint tríd' den scéim ar fáil ag www.galwaycity.ie/SRTS

Fáiltítear roimh aiseolas agus tacalocht tríd an bhfoirm ar líne (feach www.galwaycity.ie/SRTS) nó i scríbhinn, roimh an **10ú Meitheamh 2022**.

Tá foirmeacha aiseolais páipéir ar fáil ach iad a iarraidh dóibh siúd nach bhfuil rochtain dhigiteach acu, nó a bhfuil fadhbanna inrochtaineachta acu. Déan teagmháil le Comhairle Cathrach na Gaillimhe ag 091 536 400; Ríomhphost: activetravel@galwaycity.ie; Post: Comhairle Cathrach na Gaillimhe, Halla na Cathrach, Bóthar an Choláiste, Gaillimh

'School Zones'
Public Consultation



Galway City Council welcomes comments on the proposed 'School Zones' for

- Radharc Na Mara NS, Mervue;
- Scoil Iognáid, Raleigh Row;
- Galway Educate Together NS/ St Joseph's Special School, Thomas Hynes Road; and
- Scoil Bhride, Shantalla.

The School Zone will improve the 'front of school' to make it safer for children coming to and from school.

Drawings and a 'talk through' of the scheme are available at www.galwaycity.ie/SRTS

Feedback and support is welcome through the online form (see www.galwaycity.ie/SRTS) or in writing, by the **10th June 2022**.

Paper feedback forms are available on request for those without digital access, or with accessibility issues. Please contact Galway City Council at 091 536 400. Email: activetravel@galwaycity.ie Post: Galway City Council, City Hall, College Road, Galway

Social Media

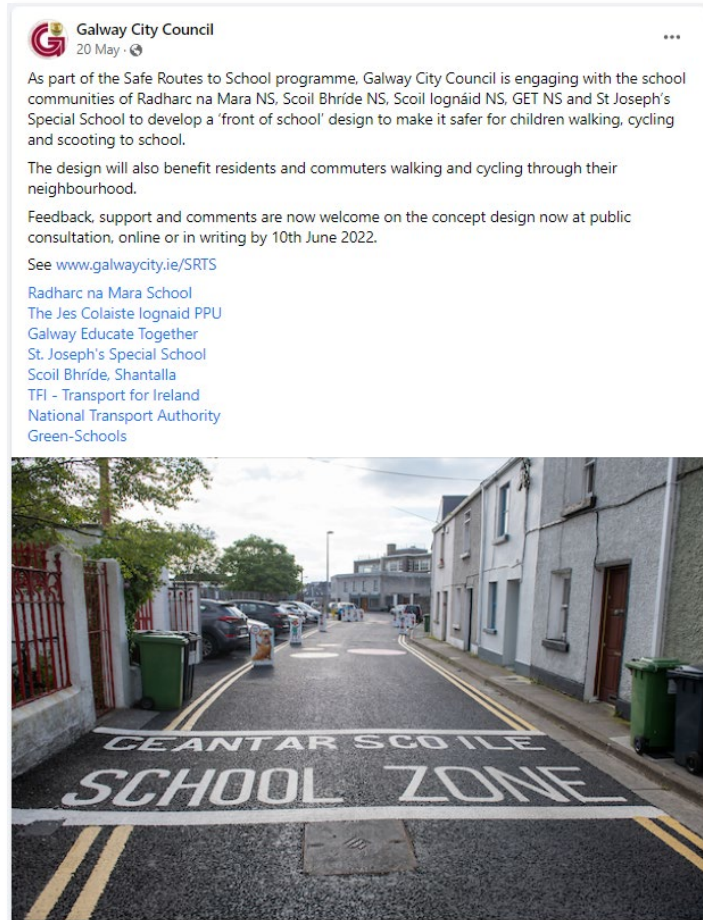

facebook



Slíte Sábháilte
Chun na Scoile
Safe Routes
To School



TOBIN
CONSULTING ENGINEERS

TRANSPORT
INSIGHTS

Consultation Summary



Slíte Sábháilte
Chun na Scoile
*Safe Routes
To School*



TOBIN
CONSULTING ENGINEERS

TI **TRANSPORT**
INSIGHTS

Consultation Summary

- 39 responses were received via the online survey
- Additional feedback was received by email
- Detailed residents' feedback was received during an on-site walkover meeting with GCC and the Design Team
- These slides summarise the above feedback, and proposed amendments to the concept School Design

Note: the graphs below show all responses including those by online survey and email.

Primary Interest in the Submission?

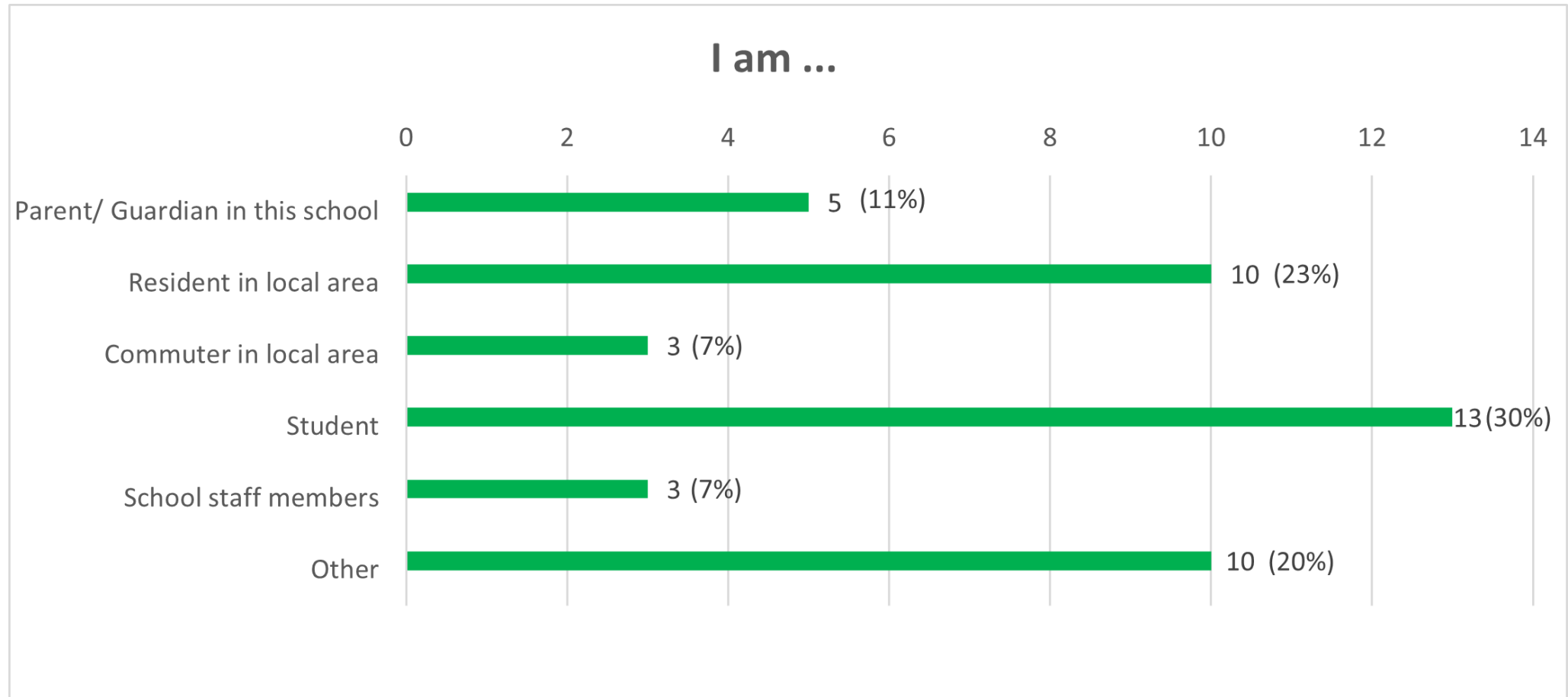

Total Responses: 44

Do you think road safety is a problem around this school?

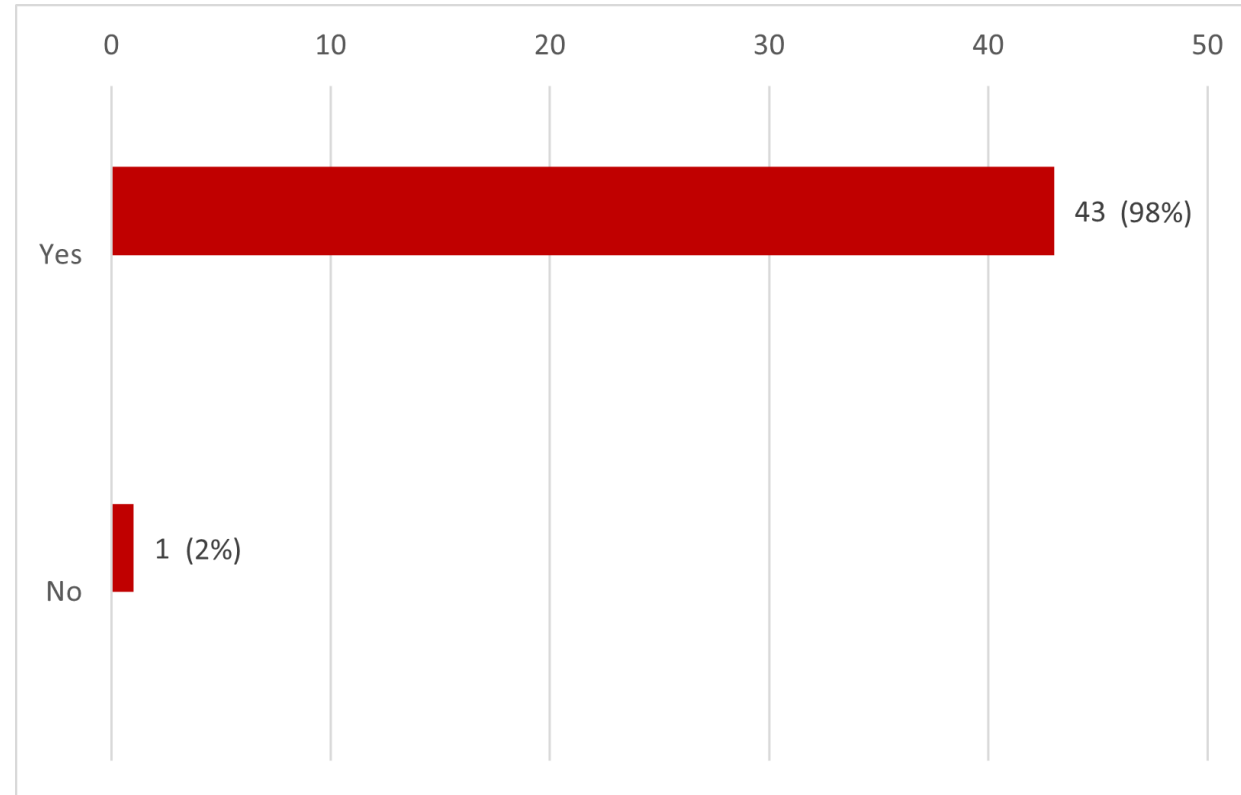

Total Responses: 44

Parents / Guardian – If you have a child/ children attending this school, how do they usually travel to school at this time of year?

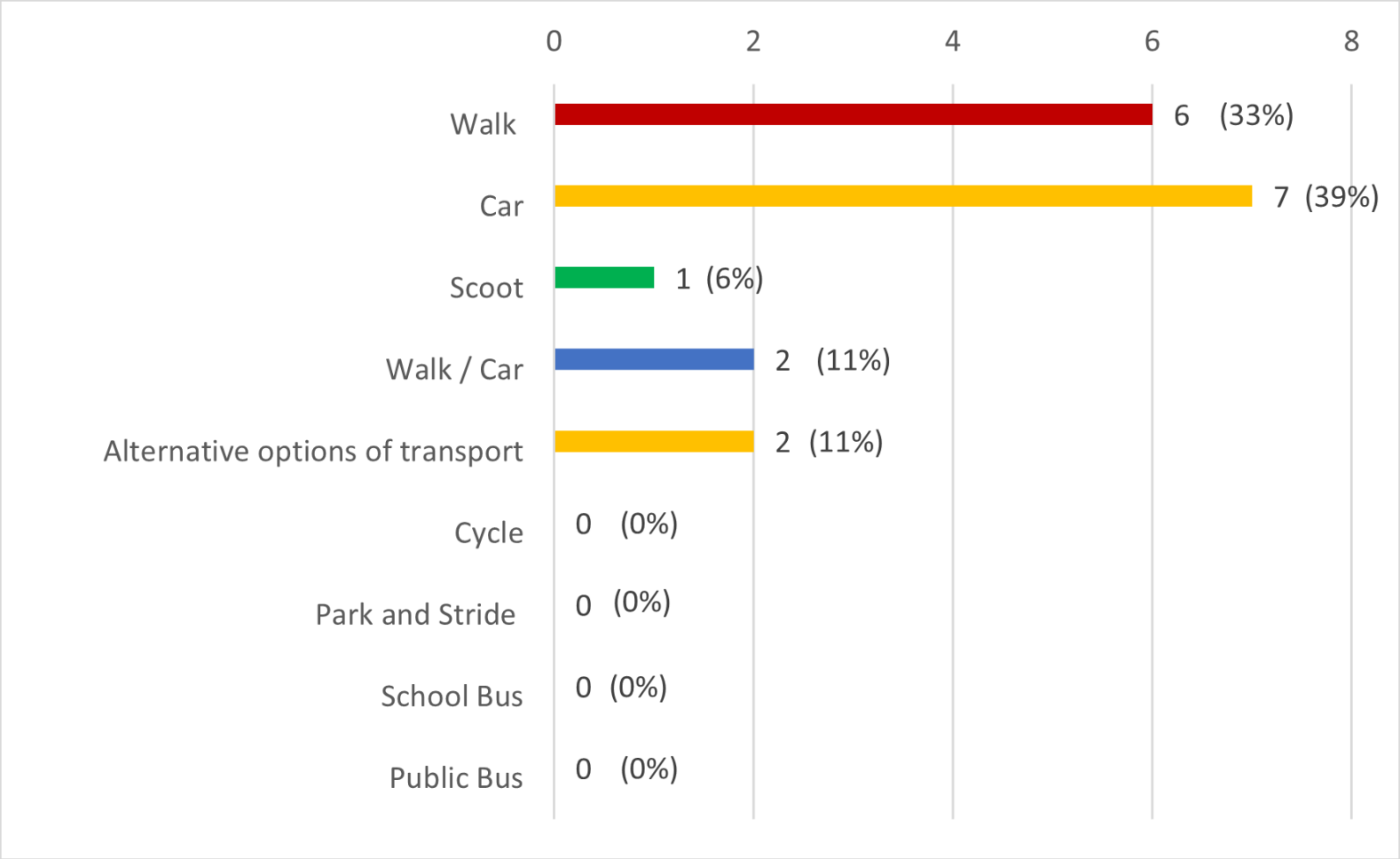

Total Responses: 18
• 5 Parents / Guardians
• 13 Students

Having reviewed the details of the proposed School Zone, please tell us what you do not like about the scheme:

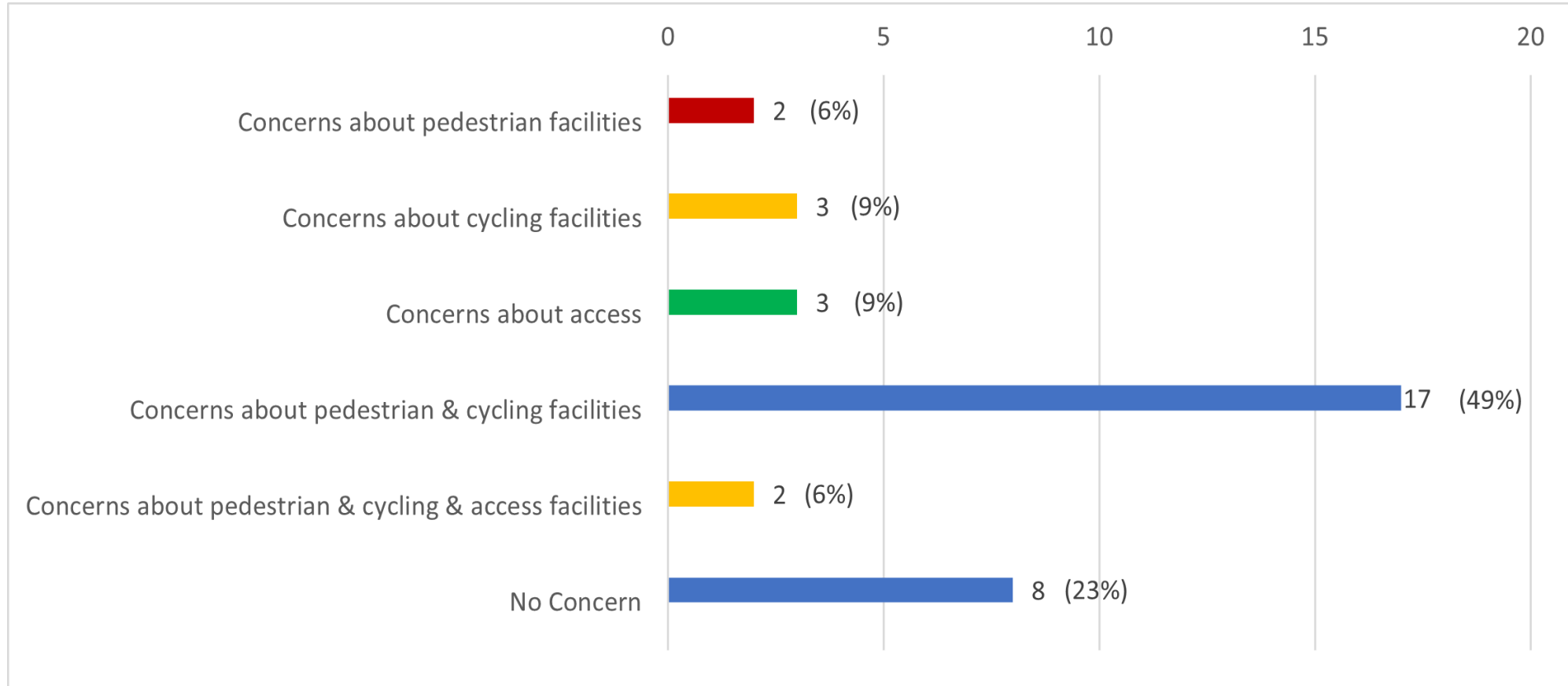

Total Responses: 35

Public Consultation Sample Comments

- Concern loss of Green space for bus lay-by & set-down
- Concern parents parking on street, with weekend activities at the school not resulting in similar on street parking concerns as school lands used for parking to facilitate these activities
- Concern bus movements are obstructed by on street parent parking
- Front of school set down being occupied by non-school related vehicles, which result in parents parking on street
- Enforcement issue of double yellow lines

- Narrow carriageway exacerbates situation for cyclists without protection for cyclists
- Gateway treatment could have additional physical deterrents to speed (i.e. chicanes / raised tables)
- Additional Raised Tables at gateway treatment, and at the junction of Colmcille Road and Shantalla Road, crossing the width of Shantalla Road in both instances
- Set down area promote further car-usage

A pedestrian crossing needs to be provided at the junction of Ashe Road and Old Seamus Quirke Road to facilitate children walking to and from estates to the north of the school.

While outside scope - Shantalla junctions need to be tightened. Pinch points & 'shared streets' without reducing vehicle volumes & speed enforcement won't enable beginner cyclists to set out on narrow streets.

The main Shantalla Road leading onto Ragoon Road needs more traffic calming measures to slow down traffic in a residential area.

Improve pathway at Maunsells Road. The parent's set down area on Colmcille road is not adequate.

The health and safety of children, parents, and staff are under constant threat because of excessive speed on the Shantalla Road.

Shantalla Road: Remove the set down, incorporating a wider footpath with pencil bollard protection. Provide additional space to facilitate cycle or other bollard protected solutions to improve cycle safety at the proposed carriageway narrowing

A continuous footpath and associated pedestrian crossing lights and markings need to be provided at the junction of Maunsell's Road and Shantalla Road to facilitate children walking to the school from the west.

- Slow down traffic.
- Set down cause issues for cyclists, it will also severely restrict visibility of pedestrians using, and motorists approaching, the proposed front of school raised table.

Having reviewed the details of the proposed concept design, please tell us what you like about the scheme:

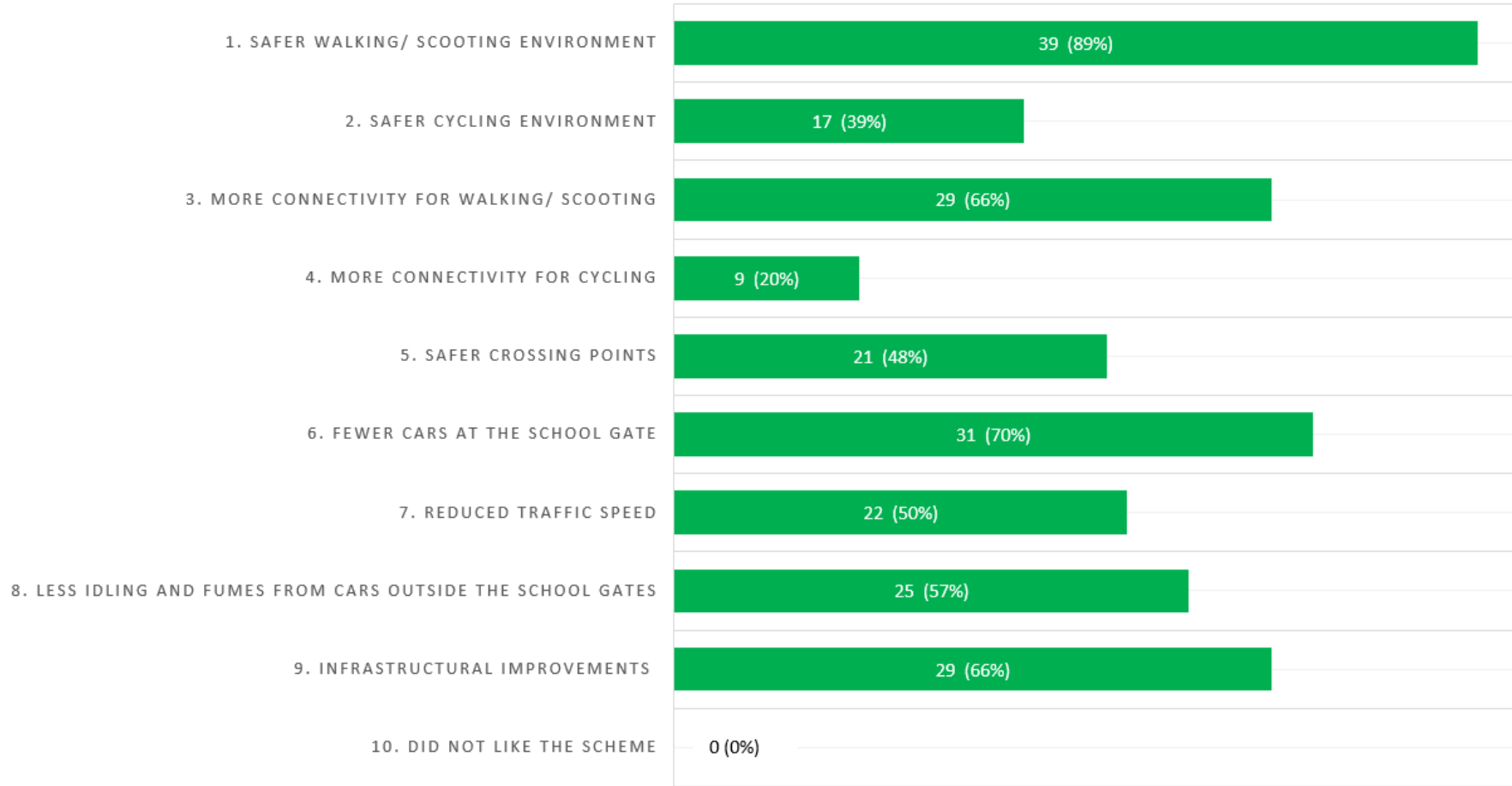

Total Responses: Range between 40 - 43

Public Consultation Sample Comments

I welcome the Safe Routes to Schools initiative and the benefits for the safety not just of school going children, but for pedestrians and cyclists in the general neighbourhood

I like the proposed narrowing of junction radii so that cars can't swing around onto side roads so quickly

We welcome the proposed School Zone plan for Scoil Bhride. There are many elements that are very positive, and which will help to make the school a safer and more pleasant place to study, work, and visit.

Bus at proposed lay-by has very low usage and very short stopping time

Provide spaces for parents to pickup their kids and a place for them to turn their car.

The pedestrian crossings and junction tightening are very much welcome. I would suggest similar junction tightening throughout Shantalla at a future point.

Use of school lands for parents drop off / pick up

Traffic congestion due to parents parking on street, due to occupied set down to front of school by non-school related traffic

The wonderful success has been the solutions-based consultations with local residents, parents, businesses & other community stakeholders as project was rolled out so everyone was aware of elimination of vehicular traffic during school drop off & pick up times ensuring children & parents - grandparents with toddlers / buggies feel safe to walk, cycle, scooter to school

Raised tables pedestrian crossings to be extended to a point further East on Shantalla Road. Road speed to be reduced to 30km in the proposed area. Illuminated school speed signs to be installed..

I would be delighted to see this proposal going ahead as Ragoon Road and Shantalla Road

I support the idea and project "school zone"

Consultation Summary

Consultation was largely positive from both residents and parents for the front of school proposal at public consultation. Not one submission stated they did not like the proposed “School Zone”.

71% of respondents liked all the proposals put forward for:

- safer walking/ scooting environment,
- connectivity for walking/ scooting

However, only 34% like the Safer crossing points.

20% of respondents liked all the proposals put forward for:

- Safer cycling environment,
- More connectivity for cycling

The respondents liked the proposals put forward with regards to vehicles:

- 76% liking fewer cars at the school gate,
- 54% liking reduced traffic speed
- 61% liking less idling and fumes from cars outside the school gates,

67% of respondents liked the proposed infrastructural improvements.

Consultation Summary

During consultation, the following concerns were raised:

- Shantalla Residents Committee:
 - Front of School:
 - High traffic speeds on Shantalla Road and Colmcille Road
 - Loss of green space amenity
 - Additional congestion due to set down area
 - Illegal parking on double yellow and zig zag markings resulting in congestion and unsafe for VRUs and local residents
 - Impact on public transport movements / stopping due to illegal parking on Shantalla Road and Colmcille Road
 - Routes to School:
 - Safer pedestrian crossing of Shantalla Road from Colmcille Road towards St. Mary's College
 - Closer Park & Stride at the Community Centre on Ashe Road to the school
 - High speeds on Ashe Road / Davis Road and unsafe crossing point for VRUs from Westside
 - Set down to front of school on Shantalla Road is occupied by non-school vehicles assisting in congestion on surrounding roads
 - Unsafe traffic movements from Davis Road to Ashe Road due to congestion
 - Pavement condition in general is poor

Consultation Summary

During consultation, the following concerns were raised:

- Local Residents:
 - Front of School:
 - High traffic speeds on Shantalla Road and Colmcille Road
 - Loss of green amenity space for bus lay-by with short stopping times and minor impact on traffic
 - Loss of green amenity space for set-down when lands available within school grounds
 - No safe spaces for parents to pickup their kids and turn their vehicle
 - Use of bio-diversity and planting over hard measures (i.e. bollards / concrete)
 - Routes to School:
 - Safety concerns at these junctions:
 - Maunsells Road/ Ragoon Road (Shantalla Road)
 - Ashe Road / Old Seamus Quirke Road
 - New Avenue-Old Seamus Quirke Road
 - Lack of cycling infrastructure on any routes / no segregation (i.e. Shantalla Road / Maunsell's Road)
 - No forewarning of cyclists on the road

Consultation Summary

During consultation, the following concerns were raised:

- Parents / Guardians / Other (i.e. Students / Staff / School Zone Committee):
 - Front of School:
 - Shantalla Road has through flow traffic with high speeds and high volume of traffic
 - Illegal parking at front of school is a safety concern for passing cyclists / reduce visibility
 - Illegal parking on footways obstructs pedestrians
 - No safe drop-off for children
 - Narrow carriageway exacerbates situation for cyclists without suitable protection for cyclists
 - Dangerous junction at Shantalla Road / Colmcille Road
 - Vehicles within the set down on Shantalla Road will obstruction visibility to pedestrians
 - Lack of disabled / mobility impaired parking for those dropping off students
 - Routes to School:
 - Unsafe junctions / lack of cycling infrastructure will not encourage walking and cycling
 - Unsafe traffic junction and through flow traffic at Seamus Quirke / Shantalla Road (i.e. Ragoon Road), right turners from Seamus Quirks
 - Unsafe route from Park & Strides

Investigate Concerns Raise at Public Consultation

Concerns to be investigated and explored following PC:

- Shantalla Residents Committee:
 - Front of School:
 - Retention of the green space as an amenity
 - Assess the requirement for a bus lay-by
 - Investigate the provision of a set-down within school grounds as utilised for parking at weekends
 - Awareness of the bus stops on Shantalla Road & Colmcille Road to prevent illegal parking / obstructions
 - Measures to prevent parking within set-down on Shantalla Road by non-school related vehicles
 - Route to School:
 - Issues flagged on the Routes to School will be examined once the Front of School design has progressed
 - Potential Bus Gate / Filtered Permeability to be assessed on Colmcille Road
 - Investigate potential new Park and Stride location at Community Centre
 - Discuss with school potential for a gamification approach with active travel earning bonus 'points'
 - Pedestrian / Scooting Improvements:
 - Controlled crossing of Shantalla Road to the east side of Colmcille Road
 - Ramp on Ashe Road and Davis Road due to high traffic speeds
 - Investigate yellow box for traffic egressing from Davis Road to Ashe Road

Investigate Concerns Raise at Public Consultation

- Local Residents:
 - Front of School:
 - Examine traffic calming measures to reduce speeds (i.e. raised tables, illuminated school speed sign)
 - Reassess set-down area on Colmcille Road within the green space with location within school grounds / alternate with bus lay-by location
 - Assess the removal of the bus lay-by and retention of green space
 - Routes to School
 - Examined the following junctions:
 - Maunsells Road/ Ragoon Road (i.e. continuous footway)
 - Ashe Road / Old Seamus Quirke Road (i.e. pedestrian crossing)
 - New Avenue-Old Seamus Quirke Road
 - Maunsells Road and Shantalla Road (i.e. raised priority pedestrian crossing with lights)
 - Cycling infrastructure on Shantalla Road will be examined and are to be addressed as part of other schemes on-going in the city.
 - Examine new Park & Stride locations and marketing through local media / schools
 - Review potential for cycling infrastructure on all approach routes (i.e. Maunsells Road)
 - Assess additional signage and road markings to indicate cyclists / scooting on the carriageway / footways
 - Incorporate bio-diversity, aesthetic pleasing and fun into the design (i.e. planting / trees)

Investigate Concerns Raise at Public Consultation

- Parents / Guardians / Other (i.e. Students / Staff / School Zone Committee):
 - Front of School:
 - Traffic calming measures to reduce speeds (i.e. ramps)
 - Prevent illegal on-street parking fronting school / on footways using bollards
 - Highlight to commuters it's a school Zone with additional Gateway Treatments (i.e. raised tables, physical gateway with kerbs / change in horizontal geometry) to encourage slower speeds
 - Investigate alternative drop off / Park & Strides (i.e. Aldi)
 - Investigate protected cycle facilities on Shantalla Road
 - Proposals to improve junction at Shantalla Road / Colmcille Road
 - Review the visibility from the pedestrian crossing to the front of school on Shantalla Road with parked vehicles in the set-down
 - Investigate the retention of the set-down as disabled parking only
 - Routes to School:
 - Investigate cycle facilities on routes to school
 - Investigate junction tightening on all routes to the school
 - Investigate removing the right turn lane at Seamus Quirke to Ragoon Road to reduce traffic
- Illegal and obstructive parking is not part of any scheme endorsed by Galway City Council, with enforcement support requested periodically through Community Wardens and Community Gardaí.

Next Steps

The next steps in the process:

- Public consultation on the concept School Zone will inform the design proceeding to the Preliminary Design Stage.
 - Public Consultation Submissions will be brought forward to the Council and the School
 - The Design Team will revise the designs based on the Public Consultation Submissions
- Following completion of the Preliminary Design, Galway City Council may, subject to the relevant consent process, undertake a second public consultation detailing the final scheme proposals.
- As part of this process, the Design Team will meet residents, parents, guardians, and the school community at public information sessions.
- The Routes to School will progress over the coming months in support of the Front of School Design.